

# UDAIPUR



**THE LEELA PALACE**

UDAIPUR

## Places of interest

City Palace and Museum  
Saheliyon Ki Bari  
Maharana Pratap Memorial  
Sajjan Garh (Monsoon Palace)  
Shilpgram  
Nathdwara  
Ranakpur

*The Leela Palace Udaipur  
offers a spectacular view of  
the tranquil waters of the  
Lake Pichola, the City Palace  
and the Aravalli mountains,  
evoking the grandeur  
and opulence of the land  
of Mewars.*

## Climate

In summer, the min is 28°C  
and the max is 43°C  
In winter, the min is 8°C  
and the max is 28°C

## General information

Languages: English, Hindi,  
Mewari  
Currency: Indian Rupee  
All major credit cards

*LAKE PICHOLA*

# UDAIPUR

The elegant and contemporary interiors of the rooms and suites at The Leela Palace Udaipur are embellished with traditional elements of Rajasthani design and artistry. With a lake facing pool, spa and an array of restaurants and superlative lounges, the palace provides a fairy-tale setting for a royal Mewar experience.

*[www.theleela.com](http://www.theleela.com)*

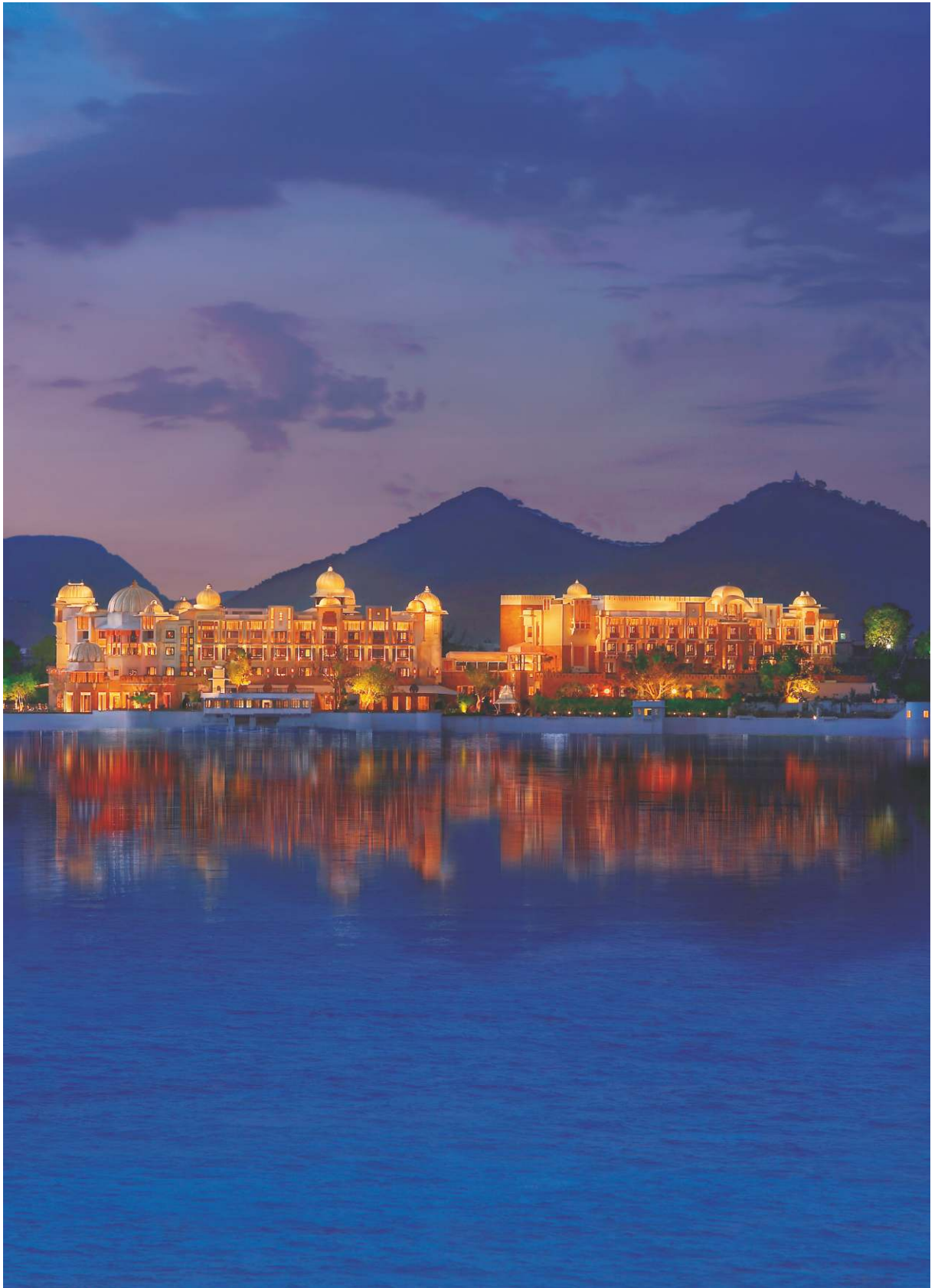

The Leela Palace Udaipur

*Welcome to a place where the age old Indian tradition of "Atithi Devo Bhava", meaning "Guest is God", is a way of life. At The Leela, everyone is committed to taking guest service to reverential heights. "Welcome to a world of grandeur & luxury"*

#### *Accommodation*

- Total no. of suites and rooms - 80
- 14 Grande Heritage Garden View Rooms
- 19 Grande Heritage Lake View Rooms
- 37 Grande Heritage Lake View Rooms with Balcony
- 2 Grande Heritage Garden View room with Private Pool
- 4 Luxury Suites
- 2 Duplex Suites
- 1 Royal Suite
- 1 Maharaja Suite

#### *Guestroom Amenities*

- High Definition LCD TV
- Broadband wireless high speed internet
- Electronic safe
- A gourmet corner with fine selection of spirits, soft beverages and snacks
- Selection of fine teas

#### *Guestroom Services*

- Round-the-clock butler service
- In-room dining
- Laundry and dry cleaning
- Wake-up call service
- Doctor on call

#### *Dining*

- The Dining Room - International cuisine
- Sheesh Mahal - Fine-dining Indian restaurant
- Walk-in wine cellar at The Dining Room
- The Library Bar - Time refined cognacs and single malts
- Destination Dining - Amrut Mahal, Sunset Alcove, Spa Alcove

#### *Conference & Banquet*

##### *Facilities*

- Marwar Conference Hall with a large open terrace
- Mewar Conference Hall
- 1 Meeting Room

- Inner Courtyard
- Outer Courtyard
- Guava Garden
- Croquet Lawn

#### *Spa and Fitness*

- The Spa
- Steam
- State-of-the-art fitness studio
- Outdoor swimming pool
- Heritage walk
- Croquet

#### *Special Features*

- The Salon
- Chauffeur driven luxury sedan cars
- Arrival in traditionally decorated boats
- Palace musicians
- Historian sessions
- Palace astrologer
- Puppet show (on request)
- Cultural performances
- Palace tuktuk





Al Fresco Dining



The Spa



Grand Heritage Lake View Room with Balcony

# BANQUET & MEETING ROOM FLOOR PLAN

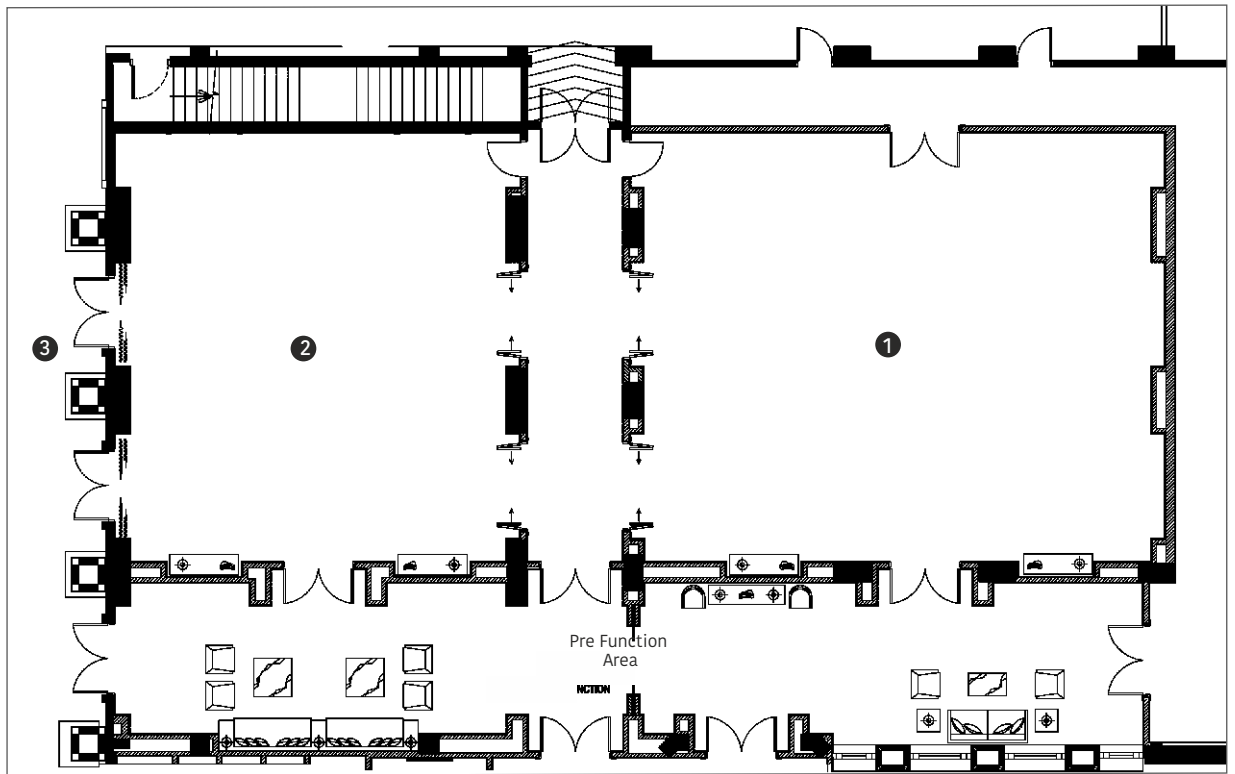

- 1 MEWAR   
 2 MARWAR   
 3 MARWAR TERRACE

VENUE	AREA SQ. FT.	DIMENSIONS L x W x H	THEATRE STYLE	CLASS ROOM	U-SHAPE	BOARD ROOM	SIT/DOWN BUFFET	CLUSTER STYLE	RECEPTION
Mewar Conference Hall	1700	46 x 37 x 13	120	60	36	48	90	72	100
Marwar Conference Hall	1295	35 x 37 x 13	60	36	24	32	60	48	60
Marwar Terrace	2788	82 x 34	160				80	85	100

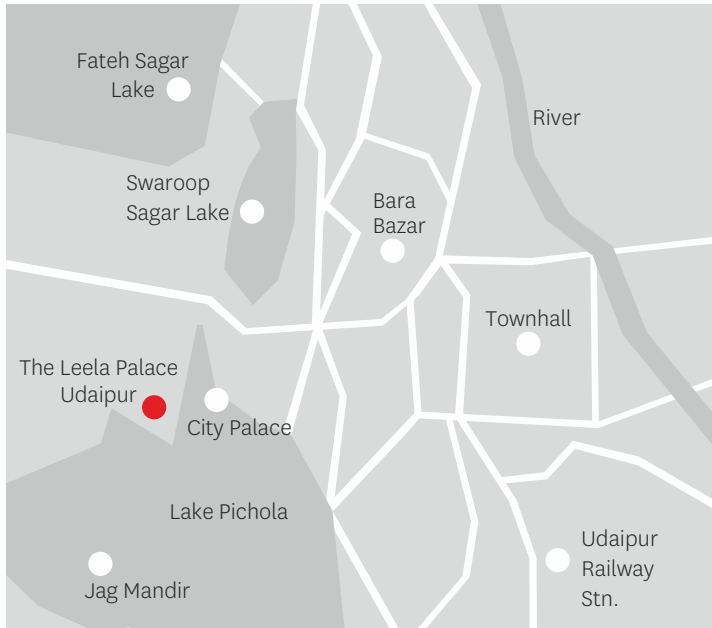

#### TRANSPORTATION

Domestic Airport, 28 km  
City Centre, 4 km

#### The Leela Palace Udaipur

Lake Pichola, Po Box No. 125  
Udaipur 313 001 Rajasthan India  
Tel: +91 294 670 1234  
Fax: +91 294 670 1212  
e mail : reservations@theleela.com

#### RESERVATIONS & INFORMATION

THE LEELA PALACES, HOTELS AND RESORTS

GDS CHAIN CODE: LR

THE LEELA RESERVATIONS

WORLDWIDE TOLL FREE

INDIA	1-800-1031-444
USA	855 670 3444
UK	08000 261 111
HONG KONG	800 906 444
SINGAPORE	1800 223 4444
PRIVATE LINES	+ 91 124 4425 444

[www.theleela.com](http://www.theleela.com)

PREFERRED HOTELS AND RESORTS WORLDWIDE

TOLL NUMBER 1 817 567 9633

#### Asia & Pacific

Australia, China, Hong Kong, India, Japan, Singapore, New Zealand, Taiwan, Thailand

#### Central & South America

Argentina, Brazil, Chile, Colombia

#### Europe

Austria, Belgium, France, Germany, Ireland, Italy, Netherlands, Norway, Russia, Spain, Sweden, Switzerland, UK

#### Middle East & Africa

Israel, South Africa, UAE

#### North America

Canada, USA, Mexico

[www.preferredhotels.com](http://www.preferredhotels.com)



**THE LEELA PALACE**

UDAIPUR

The Leela Palaces, Hotels and Resorts: Bengaluru, Chennai, Jaipur, New Delhi, Udaipur, Bhartiya City Bengaluru, Delhi, Gandhinagar, Gurugram, Mumbai, Ashtamudi, Kovalam.