

UDAIPUR



THE LEELA PALACE

UDAIPUR

Places of interest

City Palace and Museum
Saheliyon Ki Bari
Maharana Pratap Memorial
Sajjan Garh (Monsoon Palace)
Shilpgram
Nathdwara
Ranakpur

*The Leela Palace Udaipur
offers a spectacular view of
the tranquil waters of the
Lake Pichola, the City Palace
and the Aravalli mountains,
evoking the grandeur
and opulence of the land
of Mewars.*

Climate

In summer, the min is 28°C
and the max is 43°C
In winter, the min is 8°C
and the max is 28°C

General information

Languages: English, Hindi,
Mewari
Currency: Indian Rupee
All major credit cards

LAKE PICHOLA

UDAIPUR

The elegant and contemporary interiors of the rooms and suites at The Leela Palace Udaipur are embellished with traditional elements of Rajasthani design and artistry. With a lake facing pool, spa and an array of restaurants and superlative lounges, the palace provides a fairy-tale setting for a royal Mewar experience.

www.theleela.com

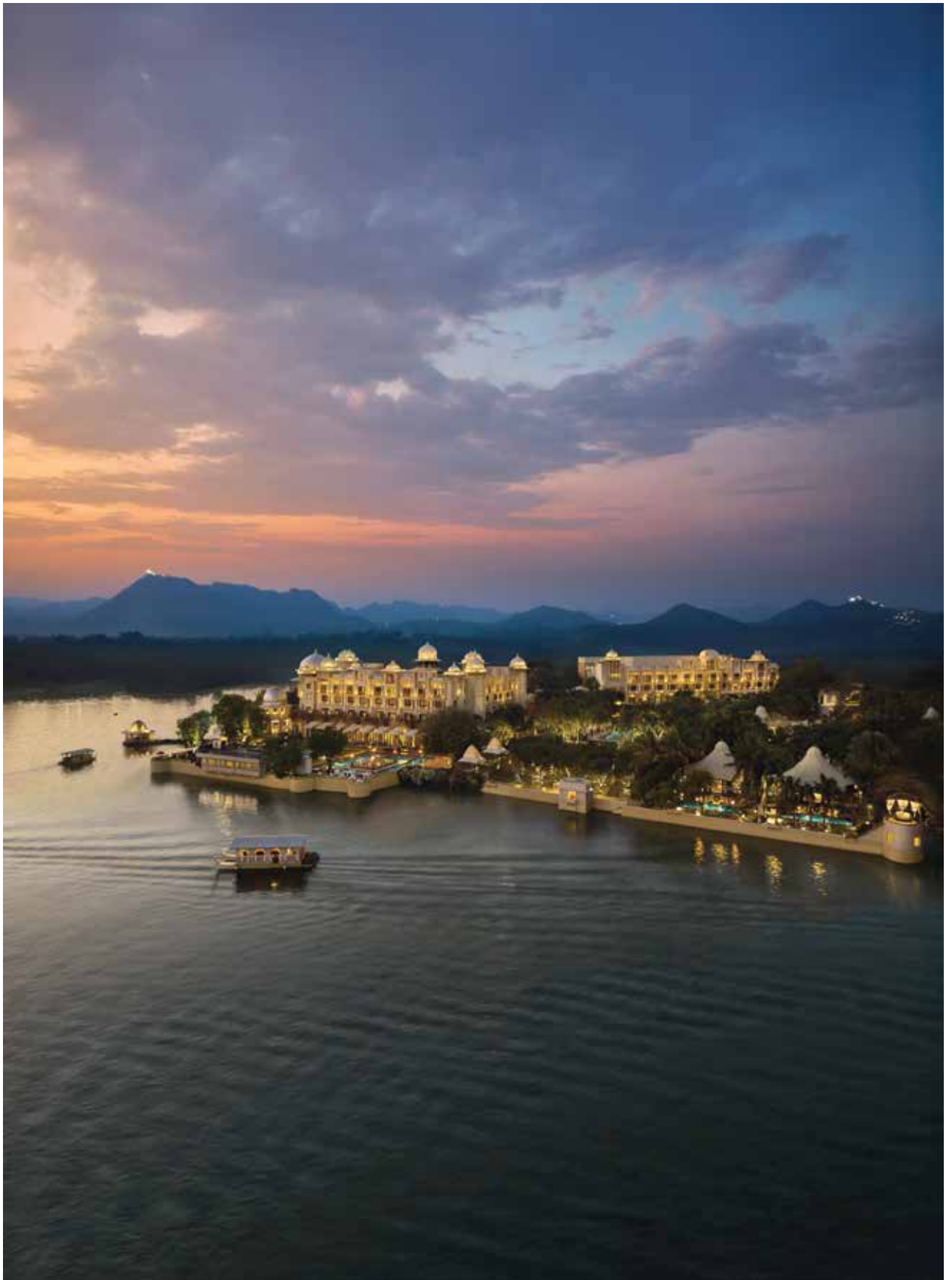

The Leela Palace Udaipur

Welcome to a place where the age old Indian tradition of "Atithi Devo Bhava", meaning "Guest is God", is a way of life. At The Leela, everyone is committed to taking guest service to reverential heights. "Welcome to a world of grandeur & luxury"

Accommodation

- Total no. of suites and rooms - 88
- 14 Grande Heritage Garden View rooms
- 20 Grande Heritage Lake View rooms
- 40 Grande Heritage Lake View rooms with Balcony
- 2 Grande Heritage Garden View room with Private Pool
- 5 Luxury Suites
- 2 Duplex Suites
- 1 Lake Villa
- 1 Lake Villa with a Private Deck
- 1 Royal Suite
- 1 Family Villa (2 Bedrooms)
- 1 Maharaja Suite

Guestroom Amenities

- High Definition Smart TV
- Broadband wireless high speed internet
- Electronic safe
- A gourmet corner with fine selection of spirits, soft beverages and snacks
- Selection of fine teas

Guestroom Services

- Round-the-clock butler service
- In-room dining
- Laundry and dry cleaning
- Wake-up call service
- Doctor on call

Dining

- The Dining Room - International cuisine
Walk-in wine cellar at The Dining Room
- Sheesh Mahal - Fine-dining Indian restaurant
- The Library Bar - Time refined cognacs and single malts
- Destination Dining - Amrut Mahal, Sunset Alcove, Sheesh Mahal Terrace, Private Deck at Arq at Pichola

Key Features of Arq at Pichola

- A regal arrival experience, with a petal shower
- A soothing foot ritual upon arrival to begin your stay in ultimate relaxation
- A regal arrival experience, with a petal shower
- Bespoke evening cocktails tailored to your tastes by skilled mixologist with a curated grill experience
- Champagne Breakfast
- An in-room bar stocked with premium liquor selection, all included in your stay
- Unwind in your temperature
- Controlled private pool with jacuzzi

Conference & Banquet Facilities

- Marwar Conference Hall with a large open terrace
- Mewar Conference Hall
- Inner Courtyard
- Outer Courtyard
- Guava Garden
- Croquet Lawn
- Sheesh Mahal Terrace

Spa and Fitness

- The Spa
- Steam
- State-of-the-art fitness studio
- Outdoor swimming pool
- Heritage walk
- Croquet

Special Features

- The Salon
- Chauffeur driven luxury sedan car
- Arrival in EV Boats
- Puppet show (on request)
- Henna Session (on request)
- Pottery Session (on request)
- Spice trail with chef (on request)
- Cultural performances
- Palace tuktuk



Dining Room



Sheesh Mahal



Luxury Suite

ROOMS AND SUITES



Luxury Suite



Duplex Suite



Maharaja Suite



Royal Suite

ARQ AT PICHOLA



BANQUET & MEETING ROOM FLOOR PLAN

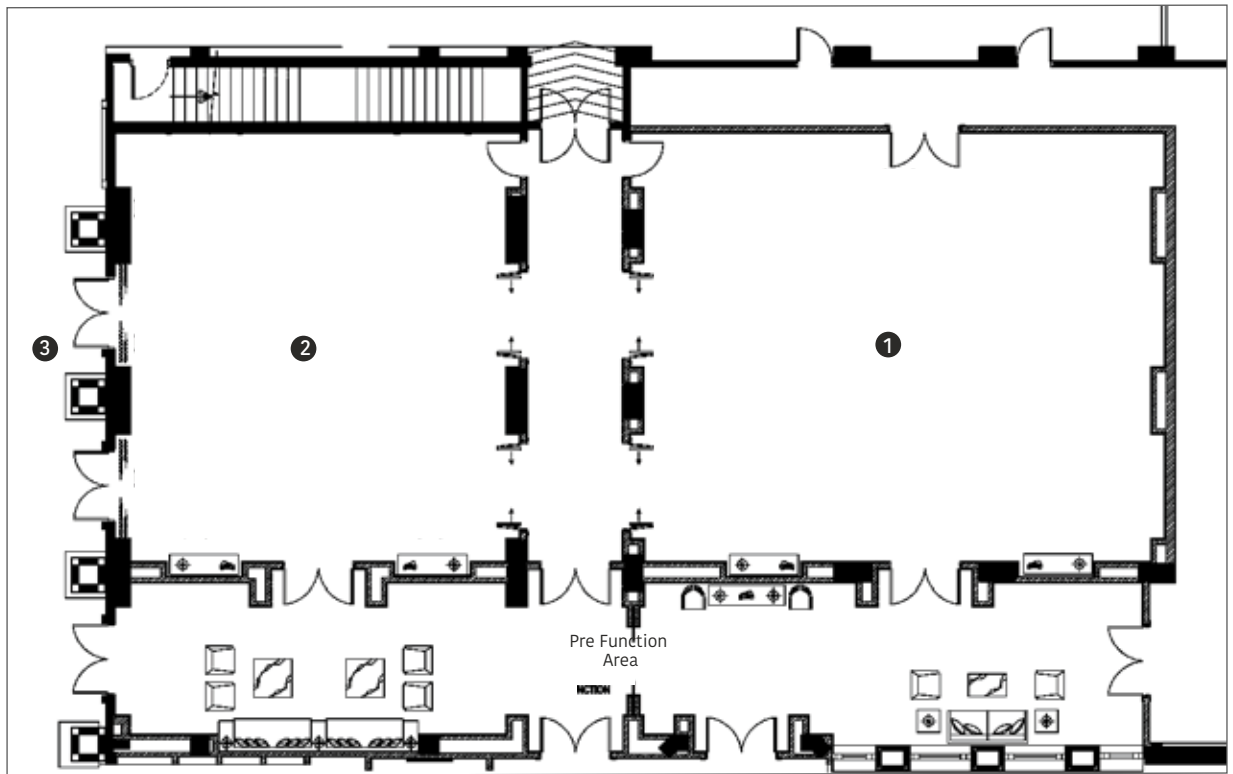

- 1 MEWAR
 2 MARWAR
 3 MARWAR TERRACE

VENUE	AREA SQ. FT.	DIMENSIONS L x W x H	THEATRE STYLE	CLASS ROOM	U-SHAPE	BOARD ROOM	SIT/DOWN BUFFET	CLUSTER STYLE	RECEPTION
Mewar Conference Hall	1700	46 x 37 x 13	120	60	36	48	90	72	100
Marwar Conference Hall	1295	35 x 37 x 13	60	36	24	32	60	48	60
Marwar Terrace	2788	82 x 34	160				80	85	100

OPEN SPACES

VENUE	AREA SQ. FT.	DIMENSION L x W x H
Outer Courtyard	13440	160 x 84
Inner Courtyard	1584	48 x 33
Guava Garden	11845	103 x 115
Sheesh Mahal Tarace	1625	65 x 25
Croquet Lawn	5980	115 x 52



Transportation: Domestic Airport, 28 km | City Centre, 4 km



THE LEELA PALACE

UDAIPUR

The Leela Palace Udaipur: Lake Pichola, Po Box No. 125, Udaipur 313 001 Rajasthan India | Tel: +91 294 670 1234
For reservations: Call 1800 1031 444 | Email: reservations@theleela.com | www.theleela.com

The Leela Palaces, Hotels & Resorts: Bengaluru, Chennai, Jaipur, New Delhi, Udaipur, Bhartiya City Bengaluru, Delhi, Gandhinagar, Gurugram, Mumbai, Ashtamudi, Kovalam and Hyderabad.